



Screwed End Ball Valves

2013NM

1000 W.O.G. / PN 63 3-PIECE FULL PORT

VMTM2013NMRSS

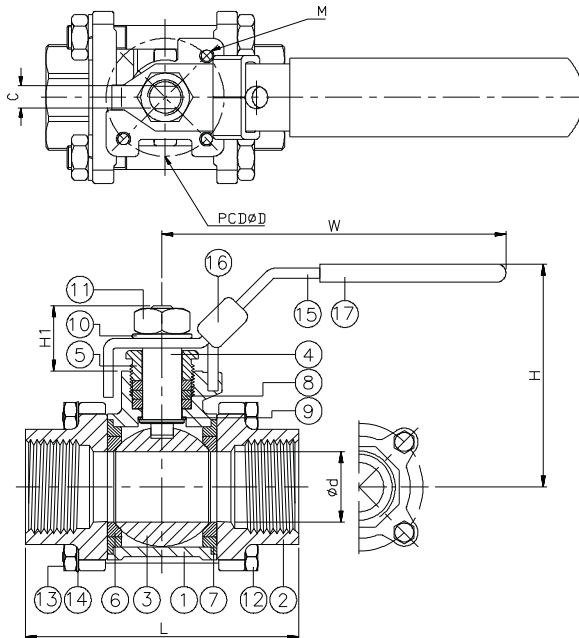

FEATURES

- Investment casting
- Blow-out proof stem
- Live-loaded design
- Anti-static device
- Easy lock handle
- ISO 5211 mounting pad

ITEM	PARTS	MATERIAL	
1	BODY	ASTM A351-CF8M	
2	CAP		
3	BALL		
4	STEM	ASTM A276-316	
5	GLAND NUT	AISI 304	
6	BALL SEAT	RTFE	
7	BODY SEAL	PTFE	
8	PACKING		
9	THRUST WASHER	AISI 304	
10	SPRING WASHER		
11	STEM NUT		
12	BOLT		
13	NUT		
14	SPRING WASHER		
15	HANDLE		
16	LOCK DEVICE		
17	HANDLE SLEEVE		PVC

PN63	DN	d	L	H	H1	W	C	D	M	ISO 5211	S	Torque (N-M)	Weight (kg)
	8	11.6	65	58.5	18	100	5	36	M5	F03	3/8"-24UNF	7.5	0.35
10	12.5	65	58.5	18	100	5	36	M5	F03	3/8"-24UNF	7.5	0.35	
15	15	65	62	18.5	100	5	36	M5	F03	3/8"-24UNF	7.5	0.5	
20	20	75	62	22.5	125	6.5	36	M5	F03	7/16"-20UNF	7.5	0.7	
25	25	85	77	25	149	7.9	42	M5	F04	7/16"-21UNF	12.5	1	
32	32	101	82	26	149	7.9	42	M5	F04	7/16"-22UNF	15	1.6	
40	38	112	100	30	190	10	50	M6	F05	1/2"-20UNC	20	2.5	
50	50	130	108	30	190	10	50	M6	F05	1/2"-20UNC	25	3.5	

PN63	NPS	d	L	H	H1	W	C	D	M	ISO 5211	S	Torque (in-lb)	Weight (lb)
	1/4"	0.46	2.56	2.3	0.71	3.94	0.2	1.42	M5	F03	3/8"-24UNF	66.38	0.77
3/8"	0.49	2.56	2.3	0.71	3.94	0.2	1.42	M5	F03	3/8"-24UNF	66.38	0.77	
1/2"	0.59	2.56	2.44	0.73	3.94	0.2	1.42	M5	F03	3/8"-24UNF	66.38	1.1	
3/4"	0.79	2.95	2.44	0.89	4.92	0.26	1.42	M5	F03	7/16"-20UNF	66.38	1.54	
1"	0.98	3.35	3.03	0.98	5.87	0.31	1.65	M5	F04	7/16"-21UNF	110.63	2.2	
1-1/4"	1.26	3.98	3.23	1.02	5.87	0.31	1.65	M5	F04	7/16"-22UNF	132.76	3.53	
1-1/2"	1.5	4.41	3.94	1.18	7.48	0.39	1.97	M6	F05	1/2"-20UNC	177.01	5.51	
2"	1.97	5.12	4.25	1.18	7.48	0.39	1.97	M6	F05	1/2"-20UNC	221.27	7.72	

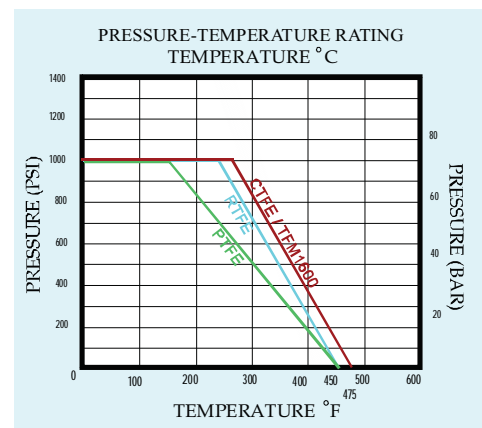

Mid-States Supply Co Inc.
Process Piping / Automation / Controls / Steam Specialties / IT Solutions



www.MidcoOnline.com

Designed, engineered, and manufactured by Haitima Corp.

042110rv2